

2 cabins - 2 head compartments

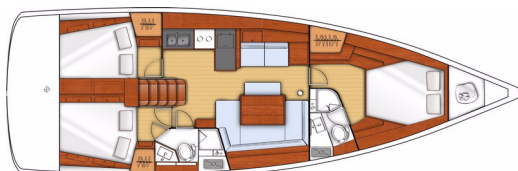

3 cabins - 2 head compartments



## GENERAL SPECIFICATIONS

• Length overall	13,94 m	45'9"
• Hull length	13,50 m	44'3"
• L.W.L.	12,98 m	42'7"
• Hull Beam	4,50 m	14'9"
• Deep draft	2,27 m	7'5"
• Deep ballast weight	2 808 kg	6,191 lbs
• Shallow draft	1,75 m	5'9"
• Shallow ballast weight	3 036 kg	6,693 lbs
• Air draft	20,60 m	67'7"
• Air draft (ICW)	19,35 m	63'6"
• Light displacement	10 549 kg	23,257 lbs
• Fuel tank capacity	200 L	53 US Gal
• Freshwater capacity (standard)	370 L	98 US Gal
• Freshwater capacity (Optional equipment)	200 L	53 US Gal
• Engine power	54 HP	54 HP
	POD 90	POD 90

## ARCHITECT / DESIGNERS

- Naval Architect: Finot - Conq And associs
- Interior design: Nauta Design

## CE CERTIFICATION

- Category A - 10 people
- Category B - 11 people
- Category C - 12 people

## STANDARD SAIL LAYOUT AND AREA

• Mainsail (classic)	50,00 m <sup>2</sup>	538 sq ft
• Genoa (104 %)	50,00 m <sup>2</sup>	538 sq ft
• Asymmetrical spinnaker	156,00 m <sup>2</sup>	1,679 sq ft
• I	17,43 m	57'2"
• J	5,65 m	18'6"
• P	16,36 m	53'8"
• E	5,43 m	17'10"



## STANDARD EQUIPMENT

### CONSTRUCTION

- Design made following European Directive requirements and according to EC certification
- Monolithic hull in polyester
- Monolithic structural hull liner bonded to the hull
- Injection molded deck in glass fiber/balsa sandwich, covered with «diamond-point» non-slip coating
- Hull-deck joint screwed, bonded and trimmed with 1 toerail
- Cast iron keel fixed with bolts and stainless steel backing plates
- Rudder hung with glass compound stock
- White colored hull - Grey metal hull decoration

### DECK EQUIPMENT

#### RIGGING

- Standard mast 9/10 anodized aluminum installed on the deck, 2 sets of spreaders
- Anodized aluminum boom
- Discontinuous stainless steel standing rigging
- 2 Backstays with turnbuckles
- Rigid boom vang
- Genoa furling system with drum on the deck
- 2 Stand Up blocks on mainsheet arch
- 2 Genoa tracks with piston adjusted traveller cars
- 2 Genoa sheet return blocks
- Rigging run back to cockpit (except boom topping lift)
- Complete running rigging: Main halyard, Genoa halyard with clutch on mast and cleat, Boom topping lift with cleat on mast, Mainsheet, 2 Genoa sheets
- 2 Reefing lines, 1 Manual reef
- 7 Line stoppers
- 2 Halyard bags

#### WINCHES

- 2 Self-tailing genoa sheet winches (H50.2 STC)
- 2 Self tailing coachroof winches (H40.2 STC)
- 2 Aluminum winch handles Speed Grip
- 2 Winch handle holders

#### SAILS

- Furling genoa with UV protective strip
- Semi full batten written sail with slider and roller slider
- System: Lazy Jack System and Lazy bag in Natural color

#### MOORING -ANCHORING GEAR

- Self-bailing chain locker - Clench bolt - Hatch cover
- Single roller stainless steel bow fitting with offset roller
- 1 12 V - 1000 W Vertical electric windlass - Remote control
- 6 Aluminum mooring cleats - Stainless steel deck line protection

#### SAIL LOCKER

- Access through deck hatch T60
- Stainless steel ladder
- Cubby hole lockers

#### SAFETY ON DECK

- 1 Open stainless steel forward pulpit - Step
- 2 Stainless steel aft pushpits
- 1 Ring lifebuoy bracket
- 1 Outboard engine bracket
- Flag mounts welded on aft pushpit
- Double lifelines and stainless steel stanchions - Access to port and to starboard in lifelines

### COCKPIT

- Self-bailing cockpit
- 2 Cockpit locker
- 2 Lockers in cockpit floor under helm's feet
- 1 Liferaft locker under helm seat, in cockpit bottom (0,80 m x 0,40 m x 0,58 m / 2'7" x 1'4" x 1'11")
- 1 Gas locker for bottle(s) under the port helm seat
- Natural solid wood slatted cockpit benches
- 2 Steering wheel consoles: Stainless steel steering wheels - 900 mm diameter - Leather covered - Steering gear at the helm station - Metal cable transmission system - Stainless steel handrail - Navigation instrument pod (optional instruments) - Glass holder
- 1 Deck plate for access to tiller system + Power supply access hatch
- 1 Emergency tiller
- 2 Steering compass on consoles
- Portside engine control and control panel
- Polyester cockpit table - 2 Flaps - Glove boxes - 2 Large storage space - 2 Stainless steel handrails - 12 V Power outlet - Lamp with shade
- 1 Cold water cockpit shower
- 1 Fixed composite arch - Built-in lighting
- 2 Hinged PMMA companionway doors - Sliding hatch made of PMMA
- Steering wheel cover white

### SWIM DECK / STERN DECK

- Fully opening transom, convertible into swim platform (2,85 m x 0,77 m / 9'4" x 2'6")
- Electrically controlled opening swim platform
- Natural solid wood decking on swim platform
- 1 Stainless steel swim/boarding ladder - Solid wood steps - Folding

### INTERIOR

- Woodwork Alpi Mahogany
- Parquet type laminated floors
- Padding upholstery in salon and cabins
- Fabric upholstery - Marine mattresses in the cabins

### COMPANIONWAY

- Headroom: 2,00 m / 6'7"
- Wooden salon companionway with molded wood hanging steps with non-slip surface
- 2 Stainless steel handrails

### SALON

- Headroom: 1,97 m / 6'6"
- U-shaped salon bench - Double density foam
- Central seating on pantograph
- Salon table in 1 piece - Varnished wood top with inlay - Aluminum legs
- Mirror on bulkhead
- Cupboard units - Cubby hole lockers and storage along the hull - Storage under bench seats
- Cubbyholes with stainless steel beading
- 2 Panoramic deck house windows with concertina blinds
- 2 Hull portholes with curtain
- 2 Opening portholes on coaming in side windows
- 1 Opening deck hatch with shutter / Mosquito screen

### CHART TABLE - PORTSIDE

- Sliding, can be configured with the armchairs - Placed against the forward bulkhead, against the galley or between the 2 mobile seats
- Table with flap - Molded wood beading
- Switch panel on bulkhead for access to electrical functions
- 1 White reading light / Red



## GALLEY - PORTSIDE

- Headroom: 2,00 m / 6'7"
- L-shaped kitchen
- Countertop of synthetic surfaces
- 1 Stainless steel sink 2 rectangular basins - 1 Mixer tap cold water / hot water, under pressure
- 1 Gas stove 2 burners - Stainless steel oven on gimbal mountings - Stainless steel protection handrail
- 1 85 L ice box / 22 US Gal, top opening
- 1 12 V 130 L refrigerator / 34 US Gal, front opening
- Fitted cupboards and closed cubbyholes (Shelving, Garbage bin)
- 1 Lower cupboard: 1 Drawer - 2 Shelves
- 1 Opening portlight with curtains in side windows in the coaming
- Storage space along the hull

## STARBOARD AFT CABIN

- Headroom: 1,96 m / 6'5"
- 1 Double bed (2,05 m x 1,50 m x 1,15 m / 6'9" x 4'11" x 3'9") - Marine mattress
- Access door to starboard aft washroom
- Cupboard units - Hanging locker - Closed cubbyholes
- Storage each side of bed
- 1 Hull portholes with curtain
- 1 Cockpit windows with curtains
- 1 Cockpit porthole with curtain
- 1 Flush deck hatch with shutter / Mosquito screen

## STARBOARD AFT HEAD COMPARTMENT

- Headroom: 1,88 m / 6'2"
- Access through salon and the starboard aft cabin
- Separate shower - 1 Mixing tap hot water / Cold water
- 1 Manual marine toilet
- 1 Rigid holding tank 80L / 21 US Gal
- Sink - 1 Mixing tap hot water / Cold water
- Washroom cabinet
- 2 Mirrors
- Toilet accessories
- Cupboard
- 1 Opening portlight with curtains in side windows in the coaming

## Version 2 cabins

### AFT-GALLEY (PORT AFT)

- Access via galley
- Large storage area (Numerous cupboards, Shelves, Drawers)
- Access door to port cockpit locker
- 1 Flush deck hatch with shutter / Mosquito screen

## Version 3 cabins

### PORT AFT CABIN

- Headroom: 1,96 m / 6'5"
- 1 Double bed (2,05 m x 1,50 m x 1,15 m / 6'9" x 4'11" x 3'9")
- Cupboard - Hanging locker - Closed cubbyholes
- Storage each side of bed
- 1 Hull porthole with curtain
- 1 Cockpit porthole with curtain
- 1 Flush deck hatch with shutter / Mosquito screen
- 1 Cockpit windows with curtains

### FORWARD CABIN

- Headroom: 1,89 m / 6'2"
- Central double bed (2,05 m x 1,50 m x 1,15 m / 6'9" x 4'11" x 3'9")
- Hanging lockers - Glove box - Cubby hole locker - Lower cupboard - Stowage under platform
- 3 Flush deck hatches with shutter / Mosquito screen
- 2 Hull portholes with curtain

## STARBOARD FORWARD HEAD COMPARTMENT

- Headroom: 1,85 m / 6'4"
- Access through forward cabin
- Manual marine toilet
- Moulded basin - Shower mixer tap hot / Cold water
- Separate shower - 1 Mixing tap hot water / Cold water
- 1 Mirror
- Washroom cabinet
- Toilet accessories
- Cupboard
- 1 Flush deck hatch with shutter / Mosquito screen

## ENGINE

- Engine Yanmar Diesel 54 hp / 54 HP Sail Drive or POD 90 Dock & Go
- Engine control - Control panel in the port cockpit
- Engine compartment: Soundproofing foam - Ventilation: 1 air intake and 1 air outlet
- 1 Alternator 12 V / 80 Ah
- 1 Rotomoulded diesel tank 200 L / 53 US Gal (under port aft berth) - Electronic gauge - Low level alarm - 1 Deck filler
- Filters: Sea water - Diesel - Decanter
- Fixed three blade propeller
- 1 Engine access through companionway (opening with 2 gas pistons) - 2 Engine access through aft cabins

## ELECTRICITY

- 12 V Circuit
- 2 Service batteries (110 Ah) - 1 Engine battery (110 Ah)
- 1 Load balancer
- 12 V Electrical panel (Fuses - Voltmeter - Water gauge - Fuel gauge - Battery warning - Fuel warning - Water warning)
- 1 12 V Power outlets
- Lighting: Overhead lights - Reading lights - Reading light White/red - White strip-lighting
- Navigation lights: 1 Forward and aft navigation lights - 1 Engine navigation light / Deck light forward of mast - 1 Mooring light on masthead
- Wire runs for options cables
- Full 115 V system (Interior power outlet 115 V - 25 Amp battery charger - Shore power socket)

## PLUMBING

- 1 Rotomolded freshwater tank (330 L / 87 US Gal Forward cabin) - 1 Deck filler
- Waterpressure system - Expansion tank - Inline filter
- 40 L Electric water heater / 11 US Gal (engine run)
- 1 Rigid holding tank 80L / 21 US Gal
- Delayed shower draining and electric shower drain pumps
- 1 Electric bilge pump - 1 Manual bilge pump
- 1 Electric ice box drain pump

## GAS

- 1 Gas bottle box in the cockpit (diameter 0,34 m x 0,53 m / 1'1" x 1'9")
- Regulator and solenoid



## TRIM LEVEL

	AVANTAGE	ELEGANCE
Zeus T7 plotter (log, speed & depth) starboard helmstation	■	■
Zeus T7 plotter (log, speed & depth) port helmstation	■	■
Simrad Windvane	■	■
Hot/cold cockpit shower	■	■
Indirect light	■	■
LED interior lights and navigation lights	■	■
2 Extra batteries + Charger (60A)	■	■
Stereo US / Ipod dock	■	■
Extra bow roller with bobstay	■	■
Counter galley solid surface "Jenna Sand"	■	■
Simrad wifi module	■	■
Companionway: Storage under the floor	■	■
Cartography B&G US	■	■
Trifunction B&G	■	■
Fender support in cockpit locker	■	■
12V freezer in place of icebox	■	■
H46STCEH electric port hal.winch		■
Fresh sea water foot pump		■
Handrails Leather covered		■
3 Burner stove in place of 2 burner stove		■
Mosquito screens		■

## PACKS

	EASY DOCKING (NOT AVAILABLE WITH DOCK & GO)	ELECTRONIC B&G
Mooring kit: 4 dock lines, Delta 20kg Anchor, 30m Chain, 45m rode, 6 fenders	■	
Bow thruster maxpower	■	
Windlass control cockpit	■	
Cockpit: Multifunction color touchscreen B&G Zeus T12 LED 12" (GPS, Chart plotter, Chart reader)		■
B&G AC 42 autopilot		■
B&G V50 VHF, function AIS receiver + Wireless handset		■

## VERSION

	DOCK & GO
Engine YANMAR Diesel Dock & Go POD 90	■
Swivel Sail Drive base	■
Joystick	■
Bow thruster	■
Auto pilot	■



## OPTIONAL EQUIPMENT

---

### Navigation electronics B&G

- 4G Radar
- Chart table: Zeus 7" wide additional multifonction screen
- Vessel Management Unit (VMU)

### Rigging - Sails

- Inner forestay chainplate
- 2 Flag halyards
- Asymmetrical spinnaker rigging + Code 0 Rigging
- Code 0 on furler
- Self-tacking jib (replacing genoa)
- Self-tacking staysail with manual furling + Fixed forestay
- Anodized mast furling system with mainsail
- Easy Sail (Genoa sheet track leads adjustable from the cockpit, Clutches on genoa sheet blocks, Backstay adjustment\*)
- ICW Roller furling mast

### Winches

- Electric genoa sheet winches - H46.2 STCEH / 50.2 STC

### Hull - Deck

- White or Grey hull
- Solid wood slatted side decks
- Silver Coachroof sprayhood
- Silver Cockpit bimini
- Dark Narval Cockpit cushions
- Remote control electric transom
- Folding gangway
- 3 Blade folding propeller
- Refrigerated ice-box in cockpit table (30 L / 8 US Gal) - Positive cold
- Windex Windvane
- White composite steering wheels
- Stainless steel Arch with davits
- Mooring cleats - Stern deck

### Interior equipment

- 7.5 KVA Generator
- 12 V / 115 V inverter - 2.000 VA
- 115 V Microwave oven
- Dishwasher (Available only in 2-Cabin version)
- Fuel forced-air heating system
- 115 V Air conditioning / 50 Hz
- Water maker (60 L / 16 US Gal / Hour)
- Double berth in salon
- Additional holding tank
- Electric QUIET FLUSH head
- Extra water tank 200 L / 53 US Gal
- Pre rigging TV + Player Fusion (Bluetooth, USB, DVD, MP3), in the salon
- Mosquito screens
- Grey upholstery padding in all cabins or Taupe
- Deluxe folding salon table (double berth compatible)
- Slat mattresses
- Interior upholstery, according to swatches

\* Except on mast with in-mast furling

