

# CUTWATER 28

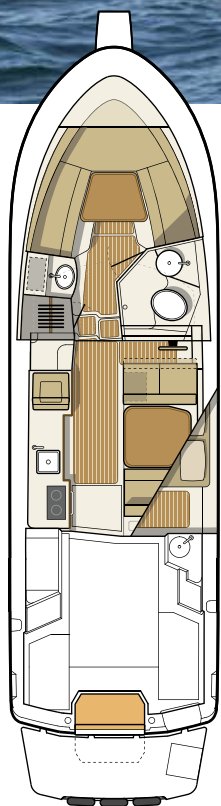

Presenting the C-28 - a sensational family cruiser, delivering a combination of performance, comfort, style and value that no other boat in its class can match. Boasting the landmark Cutwater Keel Stepped Hull design for unexcelled ride comfort, performance, handling and fuel economy, and featuring the timeless appeal of classic down-east styling.

## Specifications

LOA molded	28' 4"	8.63 m
LOA rigged (with swim & pulpit)	32' 4"	9.85 m
Bridge clearance (with folded mast)	9' 1"	2.76 m
Beam	8' 6"	2.59 m
Draft	28"	.71 m
Height on trailer	12' 8"	3.86 m
Length on trailer	37' 5"	11.40 m
Fuel capacity	100 U.S. Gal	378.5 L
Water capacity	40 U.S. Gal	151.4 L
Holding tank capacity	30 U.S. Gal	113.6 L
Weight (Dry)	8,000 lbs	3,629 kg
Engine	Volvo D4 260 HP Diesel Common Rail Electronic Engine	

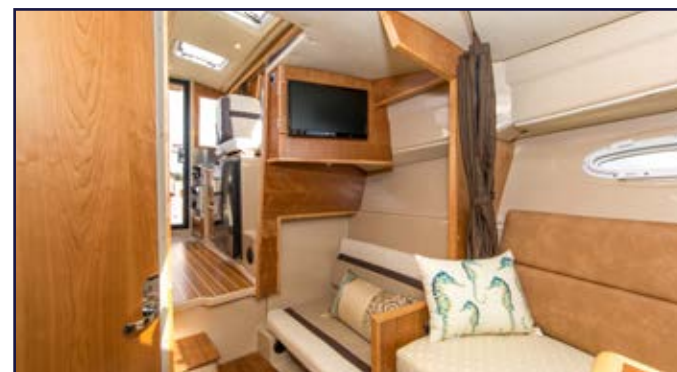



## Standard Features

### Performance

Volvo D4 260 HP diesel with color display  
Fuel flow data display  
Single-Lever engine control, electronic controls (Volvo)  
Thrusters, bow and stern  
Trim Tabs

### Boater Features

Anchor locker, S.S. self launching bow roller  
Batteries (4) w/charging relay & switch panel  
Battery charger, 20 amp, 115/230V, 3 Bank  
Bow platform w/4 rung S.S. ladder (beach access)  
Cockpit foldout seat, port and starboard, with table  
Cockpit sink and shower  
Docking lights, (2) forward hull  
Fusion stereo system, (4) speakers, AM/FM, Aux, Bluetooth  
Hatches (2), forward cabin roof, opening, translucent w/screens  
Hatches (4), salon house roof, opening, translucent w/screens  
Mast, stainless steel, hinged  
Portlight, opening, head (1), V-berth (4)  
Powered engine hatch  
Reversible cockpit seat  
Rod holders (2)  
Seawater strainer  
Sports rack  
Storage lockers  
Swim platform, w/S.S. 4 rung ladder, integrated fenders  
Transom door  
TV 19" flat screen with DVD (12v)  
Washdown system, cockpit raw water  
Water tank level monitor (fresh)  
Windlass 12V, stainless steel with helm and bow controls



### Convenience

Breakfast bar w/microwave, sink, coffee maker (NW Edition)  
Cabin heater, (Engine FWC)  
Convection oven/ microwave combo (Luxury Edition)  
Dinette, salon, converts to bed, high/low table, sleeps (2)  
Enclosed head w/shower, vessel sink, & towel rack  
Hanging locker  
Hot water tank, 6 gallon, (Eng - 110V)  
Inverter, 2,000w, PSW  
Marine head (electric flush) w/holding tank  
Microwave (NW Edition)

Midship stateroom sleeps two, 110V, 12V, reading light  
Outlets 110V (5)  
Power outlet, 12v stbd side, cockpit, mid berth  
Refrigerator/freezer, 12V  
Sink, hot and cold water system w/demand pump  
Stovetop, dual burner electric (Luxury Edition)  
Wine-water cooler, 12V

### Construction

Bonded 12V electrical system  
Bronze rudder, propeller, and thru-hulls  
Fiberglass cockpit liner, self bailing w/non-skid  
Fiberglass stringer  
S.S. cleats, rails, ext. hardware  
Shorepower 30 amp/115v, w/50' cord  
Teak and holly cabin sole  
Vinylester barrier coat (hull)

### Safety

Bilge pump, (2) 12V auto, 750 gph, high bilge alarm  
Co monitor (1), 12V  
Courtesy lights, cockpit, transom platform  
Horns, electric dual trumpet  
Illuminated Compass  
Navigation lights, with light boards  
VHF radio, Garmin with antenna, DSC capable  
Windshield wipers (2)

## Additional Factory Options

Aft cockpit sun shade with sunset shade \$1,500  
Aft cockpit bimini top with boot \$2,690  
Aft steering, second station with electronic controls \$4,970  
Aluminum triple axle trailer, electric/hydraulic brakes, spare tire w/bracket \$13,670  
Dinghy, inflatable RIB 260 CSM hypalon with Weaver davits, stand-off & winch \$4,590  
Dinghy motor, Yamaha F2.5, 4-stroke, storage bracket \$1,115  
Dinghy motor, Yamaha F6, 4-stroke, storage bracket \$1,945  
Factory Delivery Experience \$2,500  
Hull color upgrade, Midnight Blue \$5,000  
International option, 240v \$900  
Low speed module \$2,000  
Rocket launchers, arch with rod holders (6) \$1,050



## Cutwater 28 Value Package FACTORY DIRECT PRICING

All Cutwater 28's are sold **fully-equipped** and **ready to cruise**. There are two packages to choose from, the Luxury Edition with a diesel generator and air conditioning or the Northwest Edition with a diesel forced air furnace, propane stove and oven, and downrigger plugs and pads.

### Northwest Edition Includes:

- Anchor Package 16.5# anchor, 50' HT chain, 200' line
- AGM batteries
- Autopilot, Garmin w/ remote
- **Diesel Heater, forced air furnace**
- **Downrigger plugs and pads**
- LED lights
- Macerator discharge
- Navigation package, Garmin 7612, 4kw radar dome, GPS ant., depth/ff
- Swim platform rails
- Safety kit
- Solar panel, w/control panel
- **Propane stove and oven with tanks (2) and locker**
- Underwater lights

### FULLY EQUIPPED, READY TO CRUISE FROM:

**\$189,937.00\***

\*Options, freight & taxes extra

Prices, specifications, equipment and options may change without notice. 1017



MADE IN USA



### Luxury Edition Includes:

- **Air Conditioning/ rev cycle heat**
- Anchor Package 16.5# anchor, 50' HT chain, 200' line
- AGM batteries
- Autopilot, Garmin w/ remote
- **Generator, 3.5KW diesel w/sound shield**
- LED lights
- Macerator discharge
- Navigation package, Garmin 7612, 4kw radar dome, GPS ant., depth/ff
- Swim platform rails
- Safety kit
- Solar panel, w/control panel
- Underwater lights

### FULLY EQUIPPED, READY TO CRUISE FROM:

**\$204,937.00\***



17341 Tye St. S.E.  
Monroe, Washington 98272  
Phone 800.349.7198  
[www.CutwaterBoats.com](http://www.CutwaterBoats.com)